

KnitPro Interchangeable Needles : The most smart way to knit today!!
Gives you the freedom to use different sizes of needles with varied cable lengths

To fix Needle & Cable together

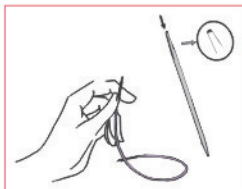

To start using the needles, screw the cable of the required length on to the hollow metal part of the needle.

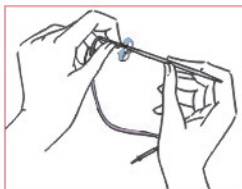

Screw the threaded end of the cable to the hollow needle end.

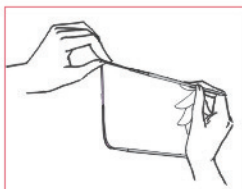

Follow the same process with the other end of the cable with the second needles.

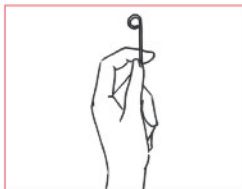

To tighten the cable to the needle on both the sides, use the cable key provided with the set.

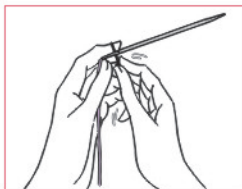

Insert the cable key into the hole provided in the cable and use it like a handle to tighten the cable and the needle together.

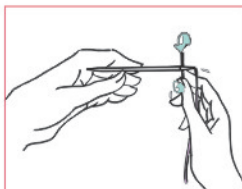

Follow the same process on the other needle and the other side of the cable.



Please check the tightening and your needle is ready for use now.

To unscrew the Needle and the Cable



When you wish to change sizes or use your needles on another project, separate the cable from the needle by unscrewing both the parts.

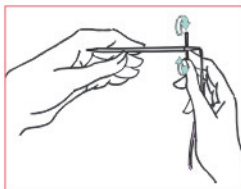

Use the cable key as a handle to unscrew the cable from the needle by inserting the key into the hole provided in the cable.

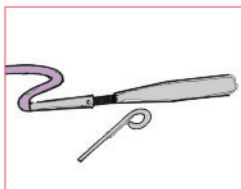

Use the key as a handle and carefully unscrew the needle from the cable.

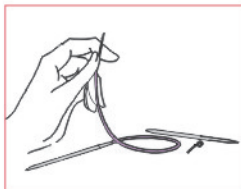

Follow the same process on the other needle.

Using the End-Caps

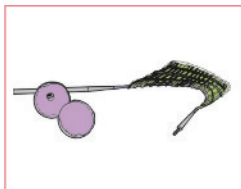

After carefully unscrewing the needle from the cable, use the end-caps given with the set to prevent your knitting slipping out from the cable.



Screw the threaded portion of the end-cap on to the cable end and tighten it properly.



Follow the same process on the other side of the cable which should also be closed with the help of end-caps.